



COLONIAL BREWING CO

PORT MELBOURNE VIC

FUNCTIONS AT CBCO.

CBCO



COLONIAL BREWING CO

Welcome to Colonial Brewing Co.

Located in Bertie Street Port Melbourne,
the brewery can accommodate any function
from small relaxed gatherings right through
to large formal occasions.

Share your special event with the brewers in
a unique venue close to Melbourne's CBD.

CBCO



FUNCTION SPACES

CBC



BREWERY HALL

A flexible, open space that can be made to suit any type of occasion. The hall can come casually furnished, or be transformed to fit your event.

Sharing a view of the brewery behind, the hall is flexible enough to cater to both standing and seated functions.

CAPACITY

80 guests seated

120 guests standing

MINIMUM SPEND

Mon – Wed N/A

(Entire venue functions only)

Thursday \$4000.00

Friday \$6000.00

(Available from 5.00pm onwards)

Saturday \$5000.00

Sunday \$4000.00

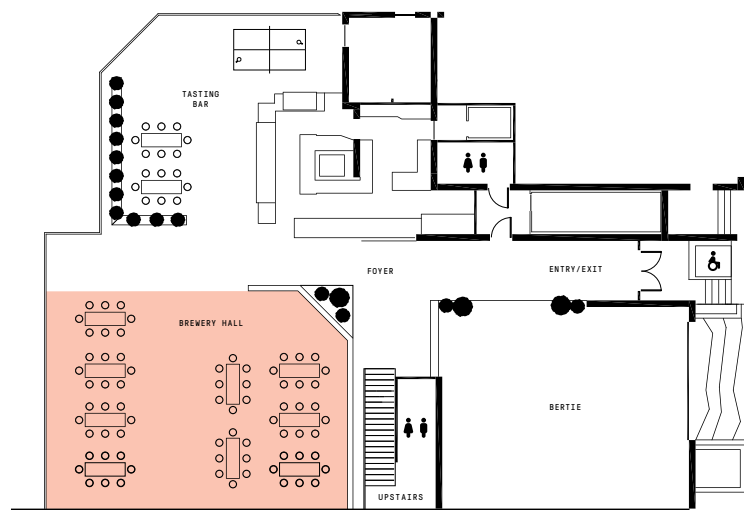

Floor plans are flexible, please speak to the functions team about the perfect set up for you



Bertie

The Bertie room is a warm, welcoming room opening out onto Bertie Street - kind of like your favourite pub, but better.

This room features a wide retractable door which opens out into a nature-strip adjacent beer garden, making it the ideal space for those long summer nights.

CAPACITY

120 guests standing

MINIMUM SPEND

Mon – Wed N/A

(Entire venue functions only)

Thursday \$4000.00

Friday \$6000.00

(Available from 5.00pm onwards)

Saturday \$5000.00

Sunday \$4000.00

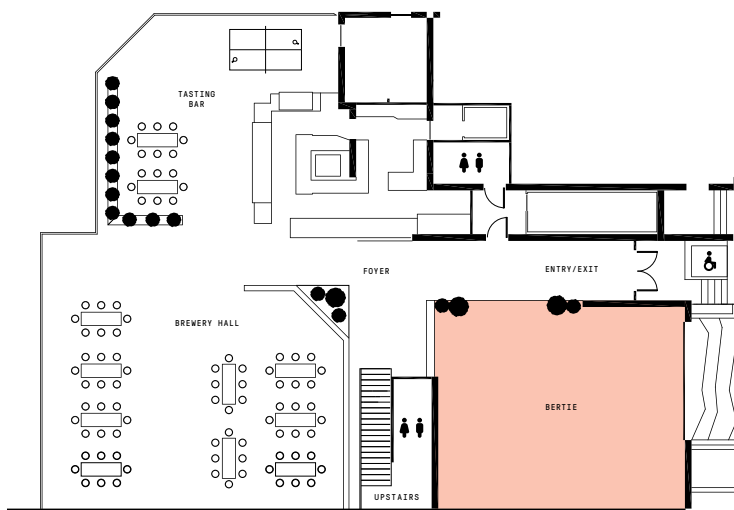

Floor plans are flexible, please speak to the functions team about the perfect set up for you



ENTIRE VENUE

Why decide, why not take the whole venue.

Utilise the flexibility of the Brewery Hall to create the perfect dance floor, or presentation area. Take advantage of the picturesque scenes created by the retractable door in the Bertie Room for a casual area for guests to sit back and relax.

Speak to our functions team to organise a time to have a walk through the venue to discuss the different options available, and to experience what hosting an event at a working brewery would be like.

CAPACITY

350 guests standing

MINIMUM SPEND

Mon – Wed \$4000.00

Thursday \$8000.00

Friday \$14,000.00
(Available from 5.00pm onwards)

Saturday \$10,000.00

Sunday \$8000.00

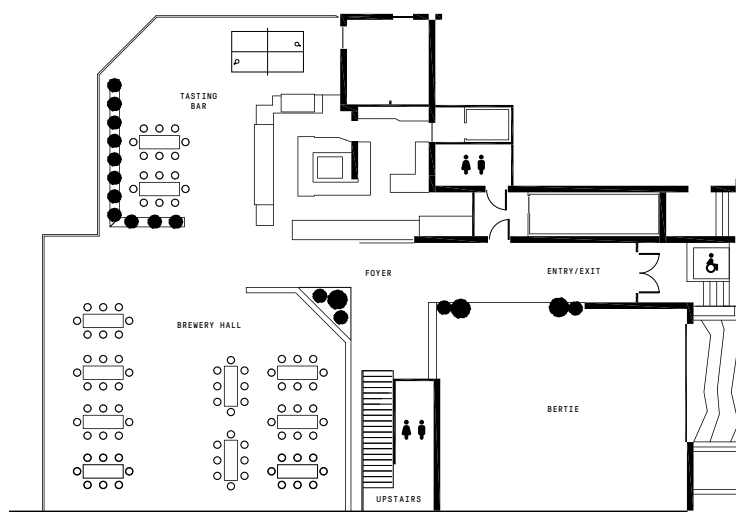

Floor plans are flexible, please speak to the functions team about the perfect set up for you

CBCO



GROUP BOOKINGS

CBC



SECTIONED OFF AREAS & TABLE RESERVATIONS

Not looking for an exclusive reservation?

Speak with our functions team to discuss sectioning off an area or simply reserving a table for your group. Catering and bar tabs can be arranged.

CAPACITY

5 – 60 guests

MINIMUM SPEND

Applicable to 'sectioned off' areas only

Mon – Wed (Not available)

Thursday \$1500.00

Friday \$2000.00
(Available from 5pm only)

Sat – Sun \$1500.00



CATERING

CBCO

CANAPÉS

We understand the important role food plays in any great function. This is why we've created a function canapé menu featuring a wide variety of options to suit any occasion. Whatever the event, we can cater to your needs. Per head packages available, speak to our functions team for a quote. Please ensure you mention any dietary requirements during the finalisation of your menu to ensure all guests are catered to.

Please have your food order in two weeks prior to your event.

SUBSTANTIAL PLATTERS (30PCS)

ALL AMERICAN SLIDERS - \$110

Beef patty, tomato sauce, cheese, mustard & pickle

TEXAS WALKER SLIDERS - \$110

Beef patty, cheese & smoky BBQ sauce

CBCO CHEESEBURGERS - \$110

Beef patty & cheese

LAMB KOFTA SKEWERS (GF) - \$110

Served with tzatziki dipping sauce

MINI PHILLY CHEESE STEAKS - \$100

Thinly sliced beef steak, cheese, onions & capsicum

FISH AND CHIPS - \$90

Crumbed flathead, shoestring fries, lemon & tartare

RICE PAPER ROLLS (V) (GF) - \$90

Vegetables in rice paper with tamari

PORK AND VEAL SAUSAGE ROLLS - \$90

Sausage rolls served with Kasundi sauce

CARAMELISED ONION & CHEDDAR TART (V) - \$90

SALT & PEPPER CALAMARI - \$90

HARISSA SAUSAGE ROLL - \$90

Served with tomato relish

SPINACH & RICOTTA ROLLS - \$90

Wilted spinach & cracked black pepper

ROAST CAULIFLOWER SALAD - \$90

CBCO PORTER PARTY PIES - \$80

ARANCINI BALLS (V) (GF) - \$80

Mozzarella and tomato

KOREAN CHICKEN - \$90

Served with Honey Soy or Spicy sauce

MAC & CHEESE CROQUETTES - \$75

BRUSCHETTA (V) - \$70

Tomato, oil, garlic & basil on toasted bread

EGGPLANT CHIPS

WITH DUKKAH (V) - \$70

Served with yogurt

PIZZA PLATTERS \$80 (20PCS)

Gourmet pizza toppings also available (20PCS) \$100- ask our functions team!

HAWAIIAN

Napoli, mozzarella, ham, pineapple

MARGHERITA (V)

Napoli, mozzarella, fresh tomato, basil

CALABRESE

Napoli, mozzarella, ham, artichoke, olive, mushroom

FUNGHI (VEG)

Mozzarella, mushroom, parsley

DESSERT PLATTERS

CHEESEBOARD (CAN BE GF) - \$12 PP

(only for groups larger than 30 people)

3 types of cheeses including fresh & imported, quince, muscatels, apple & crackers

MACAROONS (30PCS) - \$90

Assorted flavours

INQUESTIMISU (30PCS) - \$100

Tiramisu made with CBCO Inquest stout

NUTELLA DOUGHNUTS (30PCS) - \$80



SEATED & GRAZING STYLE EVENTS

Our head chef is always open to create menus to suit the occasion. Upon request tailored menus can be created to suit your event perfectly.

Please speak to us if you wish to have a look at the different packages available.

OPTIONS INCLUDE

Share style sit down menus – 2 or 3 courses available.

Smoker menus – Try something a little different with our American Style BBQ menu.

Both grazing and seated options available.

Combination Packages – Want roaming canapé entrées with a sit down main? Let us know and we will take care of the rest.

*Please note, seated style packages are available to functions of 25 – 80 guests only. Grazing Stations minimum of 25 guests.



BEVERAGE MENUS

CBCO

BEVERAGES ON CONSUMPTION

Full drinks list available on a consumption basis.

Quoted beverage packages are only available for events with fifty guests or less. Please speak to our functions team for a personalised quote for larger scale events.

BEER & CIDER 7 POT/ \$12 PINT

DRAUGHT 4.8%

Clean, crisp, light & refreshing w. subtle lemon notes

PALE ALE 4.4%

Tropical fruit flavours give way to a big, hoppy backbone

SMALL ALE 3.5%

Full-flavoured mid-strength w. big American hops

I.P.A. AUSTRALIA 6.5%

All-australian IPA w. bold passionfruit overtones

INQUEST IMPERIAL STOUT 2019 12%

Drink yourself a jacket

SOUTH WEST SOUR 4.6%

Margaret Rivers thirst quenching sour

BERTIE APPLE CIDER 4.6%

Medium-dry cider using cold pressed, Victorian apples

PROJECT BEERS

Ask the staff what we've got...

GUEST BEERS

Ask the staff what we've got...

BASIC SPIRITS \$10

SOFT DRINKS \$4

Coke, Coke Zero, Sprite, Ginger beer, Fanta, Sparkling Mineral Water

Apple juice, Orange juice

WINE

NV Dunes & Greene Sparkling, Regional Victoria 9 / 49

NV Jansz Sparkling, Pipers Brook, Tasmania 13 / 64

'18 Caves Coast Sauvignon Blanc, Margaret River, Western Australia 9 / 45

'18 Opawa Pinot Gris, Marlborough, New Zealand 11 / 54

'18 T'Gallant Moscato, Mornington, Victoria 9 / 45

'18 Hughes & Hughes Riesling, Flowerpot, Tasmania 12 / 65

'17 Brokenwood Chardonnay, Hunter Valley, New South Wales 12 / 59

'18 Le Saint André Rosé, Provence, France 12 / 59

'15 Vioque Sangiovese, Yarra Valley, Victoria 10 / 49

'15 Union Hill Shiraz, Central Victoria 9 / 45

'17 Wynns "The Gables" Cabernet Sauvignon, Coonawarra, South Australia 12 / 60

'17 Locale Clyde Park Pinot Noir, Geelong, Victoria 13 / 59

BEVERAGE PACKAGES

BASIC BEVERAGE PACKAGE

BEER & CIDER POT

Draught, Pale Ale, Small Ale,
I.P.A. Australia, South West Sour,
Bertie Apple Cider

SPARKLING

NV Dunes & Greene, Regional Victoria

WHITE

'18 Caves Coast Sauvignon Blanc,
Margaret River, Western Australia

RED

'16 Union Hill Shiraz, Margaret River,
Western Australia

2HRS DURATION \$40 per person

3HRS DURATION \$50 per person

4HRS DURATION \$60 per person

5HRS DURATION \$70 per person

Add still & sparkling waters for
\$4 extra per person

PREMIUM BEVERAGE PACKAGE

BEER & CIDER POT/PINT

Draught, Pale Ale, Small Ale,
I.P.A. Australia, South West Sour,
Bertie Apple Cider, Inquest Stout

SPARKLING

NV Jansz Premium Cuvee,
Pipers Brook, Tasmania

WHITE

'17 Opawa Pinot Gris,
Marlborough, New Zealand

'17 Brokenwood Chardonnay,
Hunter Valley, New South Wales

RED

'17 Locale Clyde Park Pinot Noir,
Geelong, Victoria

'15 Union Hill Shiraz, Margaret River,
Western Australia

2HRS DURATION \$50 per person

3HRS DURATION \$60 per person

4HRS DURATION \$70 per person

5HRS DURATION \$80 per person

Add still & sparkling waters for
\$4 extra per person



INFORMATION & BOOKINGS

CBC

TERMS AND CONDITIONS

TENTATIVE BOOKING

Any tentative bookings received will be held for a period of 7 days. Otherwise, CBCo reserve the right to release your booking. If the booking is to be made within 7 days, confirmation and deposit is required immediately.

CONFIRMATION, DEPOSIT AND PAYMENT

Signed terms and conditions and a 20% booking deposit are required within 7 days of the original reservation. All outstanding amounts must be paid by cash or credit card and settled in full on the day of the function without exception.

CONFIRMATION OF ATTENDANCE

Final numbers are required no later than 48 hours before the start time of the booking. Charges will be based on confirmed numbers or the actual attendance, whichever is greater.

MINIMUM SPEND

When stipulated, functions must adhere to the minimum spend required. Organisers are liable for the difference in the event of the minimum spend not being met. The minimum spend includes any food and beverages consumed or purchased at the event.

CANCELLATION

Refunds are made on a pro-rata basis;
3+ MONTHS: \$50 Administration fee

1-3 MONTHS: Deposit will be forfeited

LESS THAN ONE MONTH: Deposit forfeited + cancellation fee equivalent prior to event to 10% of total estimated food and beverage charges (based on last numbers provided).

LESS THAN 2 WEEKS: Deposit forfeited + cancellation fee equivalent prior to event to 20% of total estimated food, beverage and AV charges (based on last numbers provided).

LESS THAN 1 WEEK: Deposit forfeited + cancellation fee equivalent prior to event to 50% of total estimated food, beverage and AV charges (based on last numbers provided).

*Please note that rescheduling your booking is classed as a cancellation of the original date and will incur the same cancellation policies as outlined above.

PROPERTY, DAMAGE AND LOSS AND CLEANING

Whilst the staff of CBCo will take every care with the security and protection of your personal belongings, we are unable to accept responsibility for damage or loss of property before, during or after the function.

Organisers are financially responsible for any damage to the building, furniture or property during and immediately following the function. This includes any costs for repair or replacement at current market price. The organisers of the function are solely responsible for damage caused by their guests, outside contractors or agents prior to, during and after their event.

BYO & EXTERNAL CATERING POLICY

No food or beverage of any kind is permitted to be brought into CBCo for consumption by guests, with the exception of celebratory cakes.

A 'cakeage' fee of \$50 will be charged for cutting, plating and serving of any dessert for patron numbers of 20 and above.

ADDITIONAL COSTS

CBCo reserves the right to on-charge any additional set up costs such as linen, additional tables and chairs or cutlery and crockery upon mutual agreement with the function organiser. CBCo will provide a quote to the function organiser prior to the event of what costs will be incurred dependant on requirements and final numbers. For any major events such as weddings that require considerable changes to the floorplan, a fee may be applied to cover associated labour costs.

CONTENT OF EVENT

If CBCo has reason to believe that any event or function will affect the smooth running of the venue, its security or reputation, management reserves the right to cancel at its discretion without notice or liability. Some functions may require security which will be advised at the time of booking.

RESPONSIBLE SERVICE OF ALCOHOL

CBCo adheres to responsible service of alcohol legislation. All staff are trained in accordance with the Liquor Licensing Accredited 'RSA – Responsible Service of Alcohol' and by way of law may refuse to serve alcohol to any person who they may believe to be intoxicated. Any intoxicated person will be removed from the venue. In accordance with Liquor Licensing laws of Victoria, minors are only permitted on the premises in the direct company of their parent or legal guardian and may be asked to leave the venue at the discretion of management. At no time is a minor permitted to consume alcohol on the premises.

SERVICE CHARGE

A 4% gratuity applies for all events hosted on a public holiday, for non-operating hours, whole Brewery events and Fridays. (not inclusive of the minimum spend requirement).

CATERING REQUIREMENTS

Menu selections will be required 14 days prior to your event. Should selections not be advised at this point your menu selection cannot be guaranteed. Due to the seasonality of our menu, CBCo. may substitute menu items of similar quality. Every endeavour will be made to maintain selections, in situations where this is not possible we will notify you immediately.

STAFFING

Staff will be provided to deliver meals to the table/circulate canapés around the function space only, as well as maintain service of beverages behind the bar. Should you require a higher standard of service you will need to request an additional staff member at \$30 per hour for a minimum of 3 hours.



ENTERTAINMENT

Bands, DJ's and any other entertainment you wish to have at your function can be organised through our events team. If you have your own preferred contact, you may use them at the approval of CBCo management. Please note, this is only for events in which you have exclusive use of the brewery only.

AV EQUIPMENT

An additional charge of \$100 is applicable for use of the projector & screen *only available for exclusive brewery functions.

BERTIE

55" Samsung LED screen (Foxtel, freeview, laptop input, USB flash drive input, HDMI)

BREWERY HALL

In-house music system

WHOLE BREWERY

DJ equipment: 2 x CDJ 900,
1 x DJM 900 mixer, corded microphone,
2 x Thump 1000w 15" powered speakers,
2 x FOH 2000w bandroom speakers,
2 x 2000w subwoofers.

PARKING AND PUBLIC TRANSPORT

There is ample street parking available on Bertie Street and if needed, on adjacent Fennel Street. No parking restrictions apply anywhere in the vicinity.

If you wish to use public transport you can take the number 109 tram and disembark at North Port station which is a 5 minute stroll from the brewery.

OPERATIONAL BREWERY

As Colonial is an operational brewery, certain restrictions apply due to safety risks. Guests are not permitted to go beyond the confines of the public bar and allocated function spaces. To access the loading bay for deliveries, strict rules must be adhered to; confirm any access requests with your function coordinator in advance.

For any events, please note that the canning lines may be in operation; this may be a consideration for any events that require presentations, etc.

PAYMENT

CONTACT

Colonial Brewing Co.

89 Bertie Street
Port Melbourne Victoria 3207

+61 3 8644 4044

functions@colonialbrewingco.com.au

BOOKING DETAILS

Contact Name:

Company Name (if applicable):

.....

Your Booking Date: / /
DAY MONTH YEAR

Occasion:

Reserved Space:

Anticipated Guest Numbers:

Arrival Time:

Contact Number:

Email:

Signature:

PAYMENT DETAILS

☐ VISA ☐ MASTERCARD

Name on card:

Card number:

Expiry: / CVV:

Signature:

PLEASE NOTE

By signing this form, I understand and accept the above listed Terms and Conditions including all deposit, minimum spend requirements, service charge and cancellation policies.



CONTACT

Colonial Brewing Co.

89 Bertie Street

Port Melbourne Victoria 3207

+61 3 8644 4044

functions@colonialbrewingco.com.au

CBCO

89 BERTIE STREET — COLONIALBREWINGCO.COM.AU — PORT MELBOURNE